

Connector Accessories

For Miniature Size Connectors

Safety Clip

To Order Visit omega.com/smp-sc_mini_conn_acc for Pricing and Details

Model No.	Compatible Connectors
SMCL	SMPW, GMP, HMPW, HGMP
FMCL	FMP, FMPW, HFMP, HFMPW

Safety clip SMCL

Shown with GMP-T-MF



Panel Mounting Bracket (Standard and Round Hole)

Model No.	Compatible Connectors	"A" Dimension
SMACL	SMPW, GMP, HMPW, HGMP	0.88"
MACL	NMP	0.88"
SRMACL	SMPW, GMP, HMPW, HGMP	0.67"
RMACL	NMP	0.67"

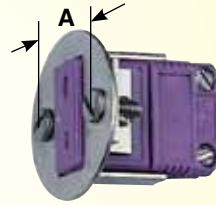

SRMACL round hole panel mounting bracket.

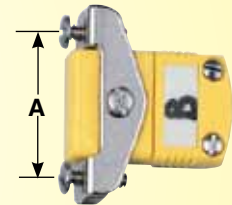

SMACL panel mounting bracket.

Wire Hole Reducer—For Smaller Gauge Wires SMPW Connectors

Model No.	Pkg of 20	Reduced Hole Opening
RB-SMP-100		2.54 (0.100") Dia.
RB-SMP-140		3.55 (0.140") Dia.



RB-SMP-100 wire hole reducers shown with SMPW-K-M

Dimensions: mm (inch)

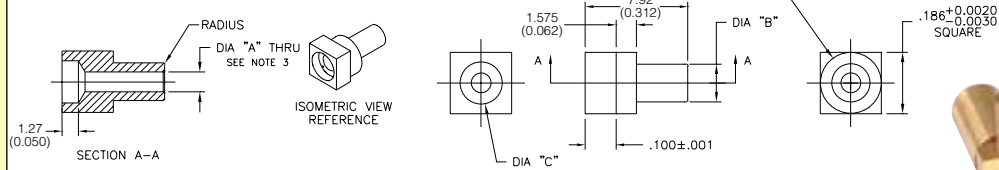

Crimp Style Bushing

Model Number	Dia A-ID mm (in)	Dia B-OD mm (in)	Dia C mm (in)	Dia E mm (in)	Compatible Connectors
(*)B-SMP-CR020-(**)	0.56(0.022)	2.95 (0.116)	3.25 (0.128)	4.72 (0.186)	SHX, NMP, MTP, GMP, SMP, SMPW, FMPW
(*)B-SMP-CR032-(**)	0.89 (0.035)	2.95 (0.116)	3.25 (0.128)	4.72 (0.186)	
(*)B-SMP-CR040-(**)	1.09 (0.043)	2.95 (0.116)	3.25 (0.128)	4.72 (0.186)	
(*)B-SMP-CR1.5MM-(**)	1.57 (0.062)	2.95 (0.116)	3.25 (0.128)	4.72 (0.186)	
(*)B-SMP-CR062-(**)	1.65 (0.065)	2.95 (0.116)	3.25 (0.128)	4.72 (0.186)	
(*)B-SMP-CR093-(**)	2.44 (0.096)	4.72 (0.186)	3.96 (0.156)	N/A	
(*)B-SMP-CR3.0mm-(**)	3.10 (0.122)	4.72 (0.186)	3.96 (0.156)	N/A	
(*)B-SMP-CR125-(**)	3.25 (0.128)	4.72 (0.186)	3.96 (0.156)	N/A	

(*) Insert "B" for brass or "S" for stainless steel
 (**) Insert quantity: "10" or "100." "CR" number indicates compatible probe diameter.

To order crimping tool for use with these bushings, specify model number **BB-SMT-CT**.

Ordering Example: **SB-SMP-CR040-100**, pkg of 100 crimp style stainless steel bushing for 0.043 Dia. probe.

PATENTED

Covered by U.S. and International patents and pending applications.

Clamp Grommets Silicone 0.25" long

Model No.	Inside Diameter	Outside Diameter	Length	Compatible Connectors
SSRT-CC-018-(*)	3.18 (0.125)	4.77 (0.188)	6.35 (0.250)	OSTW male or female
SSRT-CC-332-(*)	2.38 (0.094)			
SSRT-CC-116-(*)	1.59 (0.063)			
SSRT-CC-132-(*)	0.79 (0.032)			

*Insert pkg quantity: select from packages of 5, 10, 50, 100.

Center number denotes grommet inside diameter for 0.75" long strain relief tubing, visit omega.com

